

35th Annual Mid-South Conference on Communicative Disorders

March 17 & 18, 2005

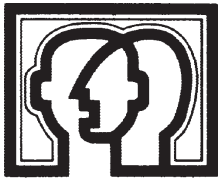

**Presented by The University of Memphis Chapter of NSSLHA
Cook Convention Center, Memphis, TN**



35th ANNUAL MID-SOUTH CONFERENCE ON COMMUNICATIVE DISORDERS

The Mid-South Conference on Communicative Disorders is presented annually by The University of Memphis Chapter of the National Student Speech-Language-Hearing Association (NSSLHA). This Conference is designed to provide both professionals and students with educational experience in current research, theories, and clinical techniques in speech-language pathology and audiology. Our hope is that all attendees will benefit from the diverse presentations on assessment and treatment of individuals with communicative disorders.

After last year's successful Conference, we are again delighted to host Mid-South at the Cook Convention Center in the heart of downtown Memphis. The Cook Convention Center is adjacent to the Memphis Marriott Downtown, and close to music, movies, food, and shopping. Downtown Memphis has recently been revitalized and supplies numerous opportunities to enjoy local flavor. A hop on the trolley is your ticket to enjoying some of Memphis' finest entertainment facilities and historical attractions. Learn about history at the National Civil Rights Museum, view the majestic Mississippi River from the banks of the Mud Island River Park, catch a movie and shop at Peabody Place, or sample a savory selection of barbeque and blues from one of the many establishments located on Beale Street.

During the Conference, we invite you to visit the Exhibitors located in the Prefunction Foyer to gather current information and resources for your clinical practice. Also located in the Foyer is the Silent Auction where you can bid on various donations received from exhibitors and local Memphis businesses. All proceeds from this auction will benefit Operation Smile. You will also have the opportunity to participate in a letter writing campaign to your Congressmen and Senators advocating support for current issues. In addition, you are invited to tour The University of Memphis School of Audiology and Speech-Language Pathology at the Memphis Speech and Hearing Center. A sign-up sheet for transportation will be posted at the registration desk.

We hope you enjoy this year as we celebrate 35 years of the Mid-South Conference on Communicative Disorders.

Rachel Phillips and Jenny Rich
2005 Program Coordinators

KEYNOTE LUNCHEON

Gloria Dodwell Kellum, Ph.D., is the Vice Chancellor of University Relations and Professor of Communicative Disorders at The University of Mississippi. She has taught in the area of speech-language pathology at Ole Miss for more than 30 years. In 1975, she won the Elsie M. Hood Outstanding Teacher Award at the University. Dr. Kellum is an ASHA Fellow. The Keynote Address is entitled **Lisa, Enrique, Sam, and Lawanda: Lessons of Life**. It is often a miracle when human communication—essential to social interaction—is practiced successfully. That means speech-language pathologists and audiologists are often miracle workers. Through clinical stories and reflections on our successes and challenges in human interactions, we can regain a sense of pride, humor, and joy from our professions. (I) ASHA 0.1, AAA 0.1

SHORT COURSE AND WORKSHOP PRESENTERS

Laura J. Ball, Ph.D. is an Assistant Professor at The University of Nebraska as well as the Augmentative and Alternative Communication (AAC) Clinical Director at the Munroe/Meyer Institute of Genetics and Rehabilitation. Dr. Ball specializes in AAC evaluations and treatment for adults and children.

Allan O. Diefendorf, Ph.D. is an Associate Professor and Director in the Department of Otolaryngology, Head & Neck Surgery at Indiana University School of Medicine and an Associate Professor at Purdue University. Dr. Diefendorf has numerous publications in the area of pediatric audiology.

Charles E. Edmiston, Jr. Ph.D., CIC is a Hospital Epidemiologist at Froedtert Memorial Lutheran Hospital and an Associate Professor of Otolaryngology in the Medical College of Wisconsin. Dr. Edmiston has been involved in local, state, and national organizations involving disease control, infections, and microbiology, and has presented worldwide on these topics.

Kris English, Ph.D. is an Assistant Professor at the University of Pittsburgh in the Department of Communication Sciences and Disorders. Dr. English is a Fellow of the American Academy of Audiology. Her research interests include the development of quantitative and qualitative techniques to measure the efficacy of counseling strategies in audiology.

Erika Hoff, Ph.D. is a Professor of Psychology at Florida Atlantic University. Dr. Hoff's research interests include language development in typically-developing children and children with language impairment. In her numerous publications, she focuses on the effects of the environment on children's language development. Dr. Hoff is a Fellow of the American Psychological Society.

Mary R. T. Kennedy, Ph.D. is an Assistant Professor in Speech-Language-Hearing Sciences at the University of Minnesota and has over 20 years of clinical experience. Her research interests include self-monitoring and narrative skills in patients with traumatic brain injury, as well as the development of guidelines for evidence-based practice.

Ann W. Kummer, Ph.D. is the Director of the Speech Pathology department at Cincinnati Children's Hospital Medical Center and a Professor in the Department of Pediatrics at the University of Cincinnati Medical Center. As a clinician, Dr. Kummer specializes in speech and resonance disorders secondary to craniofacial anomalies, cleft palate, and velopharyngeal dysfunction. Dr. Kummer is an ASHA Fellow.

H. Gustav Mueller, Ph.D. is a Professor in the Division of Hearing and Speech Sciences at Vanderbilt University. He also serves as a Senior Consultant in Audiology for Siemens Hearing Instruments. Dr. Mueller serves as a Contributing Editor for *The Hearing Journal* and has been the keynote speaker at audiology meetings in 46 states and 26 countries.

Joseph Murray, M.A. is Chief of the Audiology and Speech-Language Pathology Service at the Veteran's Affairs Medical Center in Ann Arbor, Michigan. He is currently pursuing a Ph.D. from Wayne State University. His research interests and publications are in the area of dysphagia, and he has chaired the ASHA committee to develop guidelines for FEES administration.

John L. Sandidge, M.A. is Manager at the Evelyn Trammell Voice and Swallowing Center at Saint Joseph's Hospital located in Atlanta, Georgia. Recent clinical experience includes service to persons with head and neck cancer and neurogenic disorders in acute care and outpatient rehabilitation.

MEMPHIS COOK CONVENTION CENTER

Exhibition Hall / Ballroom Level

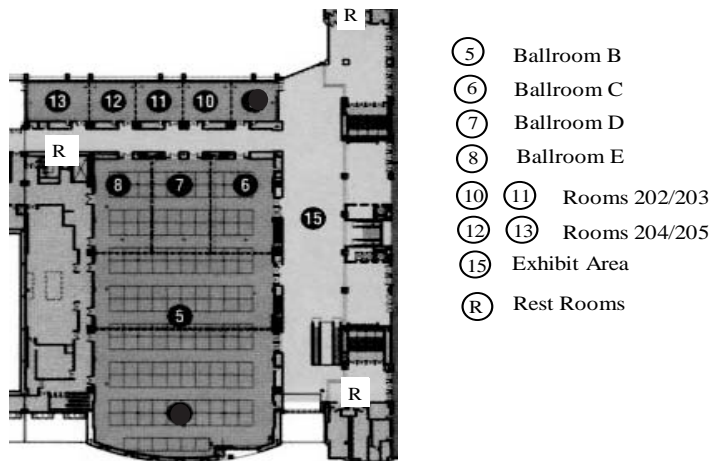

WEDNESDAY

5:00 pm - 7:00 pm REGISTRATION Prefunction Foyer- Memphis Cook Convention Center

THURSDAY

At-A-Glance

	Ballroom C	Ballroom D	Ballroom E	202/203	204/205	
8:30		SC-1 L. Ball <i>Clinical Implications of Change Associated with AAC: Lifespan Perspectives</i>	SC-2 J. Sandidge <i>Head and Neck Cancer...Physical and Emotional Survival</i>	SC-3 H. G. Mueller <i>Using Evidence Based Practice in Developing a Hearing Aid Selection and Fitting Protocol</i>		
9:00	MS-1 K. Wolfe, et al. <i>The Road Less Traveled: Audiologist and SLP as a Team</i>					
10:30						
10:45	MS-2 J. Ganey <i>Surviving Stroke: A Patient's Perspective</i>	MS-3 F. Kersting, et al. <i>Language Issues: School-Work Transitioning of Adolescents with Autism Spectrum Dis.</i>	MS-4 M. Wark <i>Exploring Generational Differences in the Workplace</i>	MS-5 B. Nicodemus & C. Thiele <i>Tennessee Pediatric Audiology Assessment and Amplification Guidelines</i>	MS-6 L. Lucks Mendel <i>Speech Perception Assessment Outcomes: Where are we now?</i>	TOUR OF MSHC
12:15	LUNCHEON IN BALLROOM B Awards Luncheon					
2:15	MS-7 M. Tully, et al. <i>The Ins & Outs of Family-Centered Intervention</i>	MS-8 D. Parham & E. Buder <i>Measuring the "Real" Thing: SLP Data Collection and Analysis Strategies</i>	MS-9 B. Antwine & A. Schmidt <i>The Career Path to SUCCESS: Following the Yellow Brick Road</i>	POSTERS / STUDENT POSTERS	MS-10 Prout & Atcherson <i>Tympanometry Revisited: Knowing Your A, B, C's and W's</i>	TOUR OF MSHC
3:45						
4:00	MS-11 S. Upson <i>The Changing World of Cochlear Implants</i>	SC-4 Invited Speaker <i>Law and Ethics: Respecting Treatment Choices Made by Our Patients</i>	SC-5 E. Hoff <i>Input and Language Development: Effects of Socioeconomic Status and Bilingualism</i>	Student Forum D. Wark	SC-6 C. Edmiston <i>Microbiology and Pharmacology: Etiology, Pathogenesis and Treatment of Infections Involving the Ear</i>	
5:00						
5:30						
6:00						

FRIDAY

At-A-Glance

	Ballroom C	Ballroom D	Ballroom E	202/203	204/205	
8:30	SC-7 A. Kummer	SC-8 J. Murray		SC-9 K. English		
9:00	<i>Part I: Clefts and Velopharyngeal Dysfunction: The Effects on Speech and Resonance</i>	<i>State of the Art of Dysphagia Assessment and Management</i>	MS-12 L Jarmulowicz, et al. <i>Phonological Awareness and Literacy</i>	<i>Counseling Patients with Hearing Loss</i>	MS-13 M. Hammett, et al. <i>The Legislative Process: Focused Initiatives to Grass Roots Advocacy</i>	
10:30						
10:45	MS-14 Roehrig & Martin <i>I Live in the Real World</i>	MS-15 C. Williams <i>Cultural Diver- sity: Perceptions on Health Care</i>	MS-16 M. Owen, et al. <i>Multiple Sclerosis and Fatigue: A Preservation of Energy</i>	MS-17 B. Cox, et al. <i>Setting Up a Quality Practice: A Panel Discus- sion</i>	MS-18 H. M. Biggs, et al. <i>Lack of Progress in Therapy...Is It the Hearing Aid?</i>	TOUR OF MSHC
12:15	KEYNOTE LUNCHEON IN BALLROOM B Dr. Gloria Dodwell Kellum Lisa, Enrique, Sam, and Lawanda: Lessons of Life					
2:15	SC-10 A. Kummer <i>Part II: Evaluation and Treatment of Resonance and Velopharyngeal Dysfunction</i>	SC-11 M. Kennedy <i>Self-regulating Learning, Language, and Communication after Traumatic Brain Injury</i>	MS-19 S. Laing <i>Phonological Awareness & Beyond: Where Angels Fear to Tread.</i>	SC-12 A. Diefendorf <i>Diagnosis of Hearing Loss in Infancy: What Constitutes "Best Practice"?</i>	MS-20 L. Craft <i>The Dizzy Patient: Assessment and Management</i>	TOUR OF MSHC
3:45						
4:15						

THURSDAY

7:30 a.m.-6:00 p.m.

REGISTRATION

Prefunction Foyer

7:30 a.m.

COFFEE & PASTRIES

Prefunction Foyer

8:00 a.m.-6:00 p.m.

EXHIBITS

Prefunction Foyer

Short Courses

Short Course 1

8:30 - 10:30 Ballroom D

Clinical Implications of Change Associated with AAC: Lifespan Perspectives

Laura J. Ball, University of Nebraska Medical Center

This session will present changes associated with AAC, including technology, population, access, and changing needs of persons using AAC. The focus will highlight clinical implementation of AAC strategies for various populations across the lifespan. Specific technologies and populations (including ALS, CAS, Aphasia, and TBI) will be discussed. (I/A) ASHA 0.2

Short Course 2

8:30 - 10:30 Ballroom E

Head and Neck Cancer...Physical and Emotional Survival

John L. Sandidge, Saint Joseph's Hospital of Atlanta

Most patients agree that quality of life during and after treatment for cancers of the head and neck is infinitely worse than living was with the acute disease process. This presentation seeks to explore the physical issues and as well as the psychosocial components that are critical to regaining some semblance of life "as it was" before diagnosis and treatment. (I) ASHA 0.2

Short Course 3

8:30 - 10:30 Room 202/203

Using Evidence Based Practice in Developing a Hearing Aid Selection and Fitting Protocol

H. Gustav Mueller, Vanderbilt University

This presentation will discuss hearing aid fitting protocols that currently are available, what works and what doesn't, and audiologists' general acceptance and use of fitting protocols. A few areas will be reviewed in depth, using an evidence based practice model to decide if this information can help us improve our fitting protocols. (I) ASHA 0.2, AAA 0.2

Short Course 4

4:00 - 6:00 Ballroom D

Law and Ethics: Respecting Treatment Choices Made by Our Patients

Invited Speaker, Medical University of South Carolina - Charleston

This presentation contrasts law and ethics, describes basic ethics principles, and reviews select legal cases pertaining to patients with swallowing impairments. A practical ethics framework is offered to assist clinicians address realistic clinical ethics problems. Participants are encouraged to bring their own cases for discussion. (I) ASHA 0.2

Short Course 5

4:00 - 6:00 Ballroom E

Effects of Socioeconomic Status and Bilingualism on Language Development

Erika Hoff, Florida Atlantic University

The nature of children's language experience varies widely. Two factors that are sources of variation are family socioeconomic status and family bilingualism. This course will help practitioners understand how low SES and bilingual backgrounds may affect children's language experience and, therefore, their language development. (I) ASHA 0.2, AAA 0.2

Short Course 6

4:00 - 6:00 Room 204/205

Microbiology and Pharmacology: Etiology, Pathogenesis and Treatment of Infections Involving the Ear

Charles E. Edmiston, Jr., Medical College of Wisconsin, Milwaukee, WI

Ear infections have a significant impact on the practice of audiology. This lecture will focus on the etiology and microbial pathogenesis of these infections, antimicrobial therapy and factors influencing the choice of therapeutic agent, common adverse side effects, and the current impact of antibiotic resistance on the treatment of middle ear infections. Because resistant microorganisms are easily spread throughout the home and work place, infection control practices in the audiology clinic will also be addressed.

(I) ASHA 0.2, AAA 0.2

Mini Seminars

Mini Seminar 1

9:00 - 10:30 Ballroom C

The Road Less Traveled: Audiologist and SLP as a Team

Kristina Wolfe, Ralph Leverett, Jeannie Luckey, and Carrie Crittendon, West Tennessee School for the Deaf

Audiology and Speech-Language Pathology are considered “sister fields”. In today’s workplace, their paths often become parallel. To become a successful team in the educational setting, their paths must converge. Using a case-study format, the team from W.T.S.D. will demonstrate the components of successful collaboration. (I) ASHA 0.15, AAA 0.15

Mini Seminar 2

10:45 - 12:15 Ballroom C

Surviving Stroke: A Patient’s Perspective

Joe Ganey, Eastman Kodak Marketing Retiree, Virginia

I would like to share my world and help you look past my disability to the true individual that I am. I hope during this brief presentation that the information I provide will help you serve your future clients. I am not a doctor or therapist, but I have been a stroke patient. (I) ASHA 0.15

Mini Seminar 3

10:45 - 12:15 Ballroom D

Language Issues: School-Work Transitioning of Adolescents with Autism Spectrum Disorders

Frank Kersting, Christen Guffey-Page, Julie Ransom, and Marty Boman, Western Kentucky University

The Speech-Language Pathologist (SLP) is critical in planning and implementing programs for young adults with communication impairments. The Kelly Autism Program is staffed by SLPs because of their training in the four language modalities. SLPs need to expand their conceptualization of support and possibilities when working in the school setting. (I) ASHA 0.15

Mini Seminar 4

10:45 - 12:15 Ballroom E

Exploring Generational Differences in the Workplace

Marilyn J. Wark, The University of Memphis

For the first time in history there are four generations in the workforce today. This presentation will explore the historical and social events that have contributed to each generation’s approach to life, education, work, and retirement with the goal of better understanding our co-workers and clients. (I) ASHA 0.15, AAA 0.15

Mini Seminar 5

10:45 - 12:15 Room 202/203

Tennessee Pediatric Audiology Assessment and Amplification Recommended Guidelines

Barbara Nicodemus, University of Tennessee, and **Carol Thiele**, The University of Memphis

The Tennessee Department of Health Newborn Hearing Pediatric Audiology Advisory Committee has recently completed pediatric audiology assessment and amplification guidelines for children from birth to age five. This presentation will include an overview of Tennessee’s EHDI program, review of the current recommended guidelines, and a discussion of the Advisory Committee’s guideline development process. (I) ASHA 0.15, AAA 0.15

Mini Seminar 6

10:45 - 12:15 Room 204/205

Speech Perception Assessment Outcomes: Where are we now?

Lisa Lucks Mendel, The University of Memphis

The current status of speech perception performance assessment will be reviewed from both objective and subjective perspectives. The relationship between objective test results and subjective self- assessment outcomes of speech perception performance will be discussed from a clinical perspective. Recommendations for improving the accuracy of speech perception assessment in the clinic will be made. (I) ASHA 0.15, AAA 0.15

Mini Seminar 7

2:15 - 3:45 Ballroom C

The Ins & Outs of Family-Centered Intervention

Melissa C. Tully, Jennifer Sanders, Helen Barry, Jill Rogers, Susan Anderson, Danielle Bell, and Veena Mehra

LeBonheur Early Intervention And Development -LEAD, Memphis, TN

Family-centered therapy is a necessity in early intervention and an effective strategy to use with clients of all ages. In this interactive session, you will learn valuable ways to improve your communication skills and actively involve caregivers in intervention. Using a transdisciplinary approach, we will assess family strengths, priorities, and daily routines, and use these assessments to develop programming and facilitate carryover of skills. (I) ASHA 0.15, AAA 0.15

Mini Seminar 8

2:15 - 3:45 Ballroom E

Measuring the “Real” Thing: SLP Data Collection and Analysis Strategies

Douglas F. Parham and Eugene Buder, The University of Memphis

Systematic problems with information collected in clinical settings can often bias clinicians’ expectations regarding functional outcomes. Such difficulties result from a variety of factors, including physiology, instrumentation, and the client-clinician interaction. This presentation will describe some of the problems inherent in SLP data collection and propose case-specific solutions. (I) ASHA 0.15

Mini Seminars

Mini Seminar 9

2:15 - 3:45 Room 202/203

The Career Path to SUCCESS: Following the Yellow Brick Road

Brenda Antwine and Angela Schmidt, HealthSouth Memphis North

Follow us down the yellow brick road as we discover the potential for success in ourselves and others. This seminar will focus on the identification of self-limiting beliefs/behaviors that impair our performance and create unnecessary suffering in our search for success. Materials presented will assist you in developing effective critical thinking skills and communicative strategies for use in interactions with co-workers, patients, families, physicians, superiors, and those in your own personal environment of friends and family.

(I) ASHA 0.15, AAA 0.15

Mini Seminar 10

2:15 - 3:45 Room 204/205

Tympanometry Revisited: Knowing Your A, B, C's and W's

Tina M. Prout and Samuel R. Atcherson, The University of Memphis

Standard tympanometry is a commonly used diagnostic tool, yet few audiologists perform multi-frequency tympanometry, which can yield valuable information regarding the status of the middle ear. This presentation will review the basic principles governing multi-frequency tympanometry and discuss instances where such testing may be desirable. Case studies will be discussed.

(I) ASHA 0.15, AAA 0.15

Mini Seminar 11

4:00 - 5:30 Ballroom C

The Changing World of Cochlear Implants

Steve Upson, Erika Studer, and Matthew Reel, Arkansas Children's Hospital, Little Rock Arkansas

The world of cochlear implants has rapidly included more groups of people as the technology and therapy associated with it has improved. The team approach to cochlear implant management, which includes speech and audiology professionals, has become essential to meet the needs of this evolving population. Current trends and technology will be discussed.

(I) ASHA 0.15, AAA 1.5

Student Forum

4:00 - 5:00 Room 202/203

David Wark, The University of Memphis

Students! This is an opportunity to talk directly with Dr. David Wark, Director of Graduate Studies in the School of Audiology and Speech-Language Pathology at the U of M. This informal question and answer period will address the admissions process, program requirements, and financial assistance.

(B) ASHA 0.1, AAA 0.1

Posters

2:15 - 3:45 Room 202/203

Factors Influencing Clinicians' Choice of Treatment Approaches in Aphasia

Caroline Royal Evans and Rick Marcus, The University of Memphis

Cross-Cultural Knowledge of Stuttering

Robert Mayo, University of North Carolina at Greensboro

Does Providing Additional Screening Information to Parents Improve Follow-Up?

Mary T. Consolini, Tanya S. Enloe, and Lila J. Carson, Valdosta State University

Selection and Treatment Techniques for Voice Therapy

Teresa Wolf and Jessica Balderson, The University of Memphis

Graduate Student Training: Planning a Comprehensive Therapy Program for Preschoolers

Marion C. Hammett, Laura S. Martin, and Georgie Goldsmith, The University of Memphis

Two Years with Late Talkers: Considerations for Positive Outcome

Elizabeth Nowlin Witt, Louisiana State University Health Sciences Center

Comparative Study of Two Approaches to Sound Remediation

Sandra Hayes, Louisiana State University Health Sciences Center

Student Posters

Analysis of Hearing Screening Data with Persons with Mental Retardation

Alexandria Groves, C.E. Byrd High School, **Debra Laing**, Northwest Louisiana Developmental Center, and **Gay T. Vekovius**, Louisiana State University Health Sciences Center

Frequency and Type of Communicative Effort and Play Participation of Two Late Talkers

Talicia D. Johnson, Louisiana State University Health Sciences Center, **Jessica Darby**, C.E. Byrd High School, and **Elizabeth Nowlin Witt**, Louisiana State University Health Sciences Center

Variation in Speech Spectra with Microphone Placement: Implications for Children

Jani Johnson, **Doug F. Parham**, and **Eugene H. Buder**, The University of Memphis

Job Satisfaction and Burnout: Speech-Language Pathologist-Client Relationship

Dana Power, Louisiana Tech University

(I) ASHA 0.15, AAA 0.15

FRIDAY

7:30 a.m.-2:00 p.m.

7:30 a.m.

8:00 a.m.-4:00 p.m.

4:00 p.m.

REGISTRATION

COFFEE & PASTRIES

EXHIBITS

SILENT AUCTION

Prefunction Foyer

Prefunction Foyer

Prefunction Foyer

Prefunction Foyer

Short Courses

Short Course 7

8:30 - 10:30 Ballroom C

Part I: Clefts and Velopharyngeal Dysfunction: The Effects on Speech and Resonance

Ann W. Kummer, Cincinnati Children's Hospital Medical Center, University of Cincinnati Medical Center

Part I of this seminar will give the clinician a clear understanding of normal anatomy and physiology of the oral cavity and velopharyngeal mechanism. A discussion of how abnormal oral and pharyngeal structure affects speech, language and resonance will follow, with a special focus on velopharyngeal dysfunction and resonance disorders. (I) ASHA 0.2

Short Course 8

8:30 - 10:30 Ballroom D

State of the Art of Dysphagia Assessment and Management

Joseph Murray, Veteran's Affairs Medical Center, Ann Arbor, Michigan

Clinicians combine objective science, personal experience, and conventional wisdom when interpreting instrumental swallowing assessments. This is a service that is delivered daily, in large numbers, by clinicians that have unequal training and experience. This session will focus on variability in the assessment and delivery of treatment for dysphagic patients. (I/A) ASHA 0.2

Short Course 9

8:30 - 10:30 Room 202/203

Counseling Patients with Hearing Loss

Kris English, University of Pittsburgh

Audiologists are very familiar with the range of psychological, emotional, and social difficulties that may occur as a result of hearing loss, but most report feeling underprepared in effectively supporting patients and families with these concerns. This presentation will provide an overview of basic counseling strategies. (I) ASHA 0.2, AAA 0.2

Short Course 10

2:15 - 4:15 Ballroom C

Part II: Evaluation and Treatment of Resonance and Velopharyngeal Dysfunction

Ann W. Kummer, Cincinnati Children's Hospital Medical Center, University of Cincinnati Medical Center

In Part II of this seminar, methods for the evaluation of speech, resonance, and velopharyngeal function will be described, including the use of high-tech, low-tech, and "no-tech" procedures. Finally, treatment options will be discussed, including surgery, prosthetic devices, and speech therapy. Specific therapy techniques will be described and demonstrated. (I) ASHA 0.2

Short Course 11

2:15 - 4:15 Ballroom D

Self-regulating Learning, Language, and Communication after Traumatic Brain Injury

Mary R. T. Kennedy, University of Minnesota

Accurate self-monitoring and strategy use are critical to self-regulation, though often impaired after a TBI. Recent research on how beliefs, self-monitoring, and strategy decisions interact will be presented, followed by evidence-based practice recommendations for management strategies that target these aspects of self-regulation. Finally, participants will be provided with tools for evaluating future evidence. (I/A) ASHA 0.2

Short Course 12

2:15 - 4:15 Room 202/203

Diagnosis of Hearing Loss in Infancy: What Constitutes "Best Practice"?

Allan O. Diefendorf, Indiana University School of Medicine, Indianapolis, Indiana

It is optimal when hearing loss is confirmed and intervention is initiated within a child's first 6 months of life. As such, the efficiency and effectiveness of how we approach the audiologic work-up is critical, as intervention options rely on timely and accurate diagnosis of hearing loss. This presentation focuses on what constitutes "Best Practice" in audiologic diagnosis. (I) ASHA 0.2, AAA 0.2

Mini Seminars

Mini Seminar 12

9:00 - 10:30 Ballroom E

Phonological Awareness and Literacy: Views Across Populations

Linda Jarmulowicz, The University of Memphis, **Darlene Winters**, Private Practice, **JoClaire Merrill**, Madonna Learning Center
This panel discussion will first present current research on phonological awareness (PA). Then, SLPs will discuss the implementation and possible benefits of teaching PA skills to other populations (Down Syndrome/MR, younger preschoolers). Discussion will be encouraged. (I) ASHA 0.15

Mini Seminar 13

9:00 - 10:30 Room 204/205

The Legislative Process: Focused Initiatives to Grass Roots Advocacy

Marion Hammett, The University of Memphis, **Mary Dale Fitzgerald**, Tennessee State University, and **David Wark**, The University of Memphis
The TN Legislative Councilors to ASHA will present the selection process for focused initiatives - from identification of issues to recommendation of the focused initiatives for the association. Grass roots advocacy and an update on current legislative concerns will be discussed. (I) ASHA 0.15, AAA 0.15

Mini Seminar 14

10:45 - 12:15 Ballroom C

I Live in the Real World

Sharon A. Roehrig and Laura S. Martin, The University of Memphis

These presentors will discuss issues to be considered in making communication therapy relevant and functional for school-aged children with severe mentally handicapping conditions. They will address goals, strategies, settings, and activities and will supplement lecture with videotaped examples. (I) ASHA 0.15

Mini Seminar 15

10:45 - 12:15 Ballroom D

Cultural Diversity: Perceptions on Health Care

Charles Williams, The University of Memphis

Dr. Williams, an expert in anthropology, will provide an overview of different United States cultures and their attitudes towards health care providers. A panel discussion involving representatives from various cultures will follow. Questions and insights are encouraged from the audience. (I) ASHA 0.15, AAA 0.15

Mini Seminar 16

10:45 - 12:15 Ballroom E

Multiple Sclerosis and Fatigue: A Preservation of Energy

Mike Owen, Louise Williams Owen, Smithville, TN; **Sheila Kernan**, MS Society of Memphis

Fatigue impacts individuals with multiple sclerosis in almost every aspect of life. Mike Owen and his wife Louise, a speech language pathologist, will share their personal experience in dealing with the effects of multiple sclerosis (MS), as well as discuss compensatory strategies and clinical considerations in preserving energy. A representative from the MS Society of Memphis will give background information and increase awareness for resources in the Memphis community. (I) ASHA 0.15, AAA 0.15

Mini Seminar 17

10:45 - 12:15 Room 202/203

Setting Up a Quality Practice – A Panel Discussion

Ben Cox, Memphis Hearing Aid and Audiological Services, LLC, **Katharine Sorenson**, Memphis Hearing Solutions, **Sheri E. Weiner**, Hearing Services of Tennessee, **Marilyn Gresham**, Ear Nose and Throat Group, Inc.

Each panelist will provide a personal viewpoint on important aspects of setting up a quality audiologic practice. Information presented will include, but is not limited to, finding a place to set up your practice, financial and personal costs associated with the business, scheduling, customer focus, diagnosis, and rehabilitation. (I) ASHA 0.15, AAA 0.15

Mini Seminar 18

10:45 - 12:15 Room 204/205

Lack of Progress in Therapy...Is It the Hearing Aid?

Holley-Marie Biggs, The University of Memphis, **Susan Lopez, Rebecca Lowe, Maggie Ellard, and Landon Rutherford**, University of Mississippi

SLPs often are first to address suspected hearing aid problems; but may need help verifying their suspicions. This session teaches attendees about features available on hearing aids with advanced technology; how to subjectively check hearing aid function; and objective steps audiologists take to ensure proper hearing aid function. (I) ASHA 0.15, AAA 0.15

Mini Seminars

Mini Seminar 19

2:15 - 3:45 Ballroom E

Phonological Awareness & Beyond: Where Angels Fear to Tread

Sandi Laing, University of Alabama

The mini-seminar will cover the acquisition of phonological awareness and decoding, as well as characteristics of proficient reading. This will be followed by a discussion of specific profiles of reading difficulty and suggestions for assessment and intervention.

(I) ASHA 0.15

Mini Seminar 20

2:15 - 3:45 Room 204/205

The Dizzy Patient: Assessment and Management

Lisa M. Craft, Central Mississippi Medical Center

Disorders of balance are among the most common encountered in clinical medicine. This course is focused on the diagnostic and therapeutic considerations of a variety of balance disorders.

(I/A) ASHA 0.15, AAA 0.15

Level of Difficulty: Beginning (B) - Intermediate (I) - Advanced (A)

*We would like to thank Ed Brainerd for his continued computer support.
Cover design by Brian Borgman, with help from Rachel Phillips and Jenny Rich*

UOM 53-0405/3M
Baber, Inc.
3135 Milbranch
Memphis, TN

HOTEL

The Mid-South Conference will be held at **The Memphis Cook Convention Center**, which is located in downtown Memphis at Interstate 40 and Front Street. Parking will be \$7.00 per day. Use the Front Street entrance to park. Sessions will be held on the Exhibit Hall/Ballroom Level.

Hotel accommodations are available at the **Marriott Hotel Downtown** adjacent to the convention center. This newly renovated hotel offers many specialized services and luxurious accommodations, including an exercise room and indoor pool. Individuals should call the Downtown Marriott for reservations at 1-888-557-8740. In order to receive the special group rate (\$109/night), you must indicate that you are attending the **Mid-South Conference on Communicative Disorders**. We encourage participants to make reservations as soon as possible. All requests should be made no later than **February 23, 2005**. Reservation requests after this date are subject to availability, and rates higher than the group rate may apply.

CONTINUING EDUCATION

NSSLHA-The University of Memphis is approved by the Continuing Education Board of the American Speech-Language-Hearing Association (ASHA) to provide continuing education activities in speech-language pathology and audiology. This program is offered for 1.2 CEUs (various levels; professional area). ASHA CE Provider approval does not imply endorsement of course content, specific products, or clinical procedures. **ASHA now requires an ASHA membership number rather than a social security number for CE registration.**

NSSLHA- The University of Memphis is approved by the American Academy of Audiology to offer Academy CEUs for this activity. The program is worth a maximum of 1.2 CEUs. Academy approval of this continuing education activity does not imply endorsement of course content, specific products or clinical procedures.

* NOTE: One contact hour is equivalent to 0.1 ASHA/AAA CEU. Fractions of hours are dropped when calculating the CEU total.

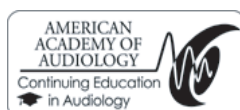

THE UNIVERSITY OF
MEMPHIS

The University of Memphis, a Tennessee Board of Regents institution, is an Equal Opportunity/Affirmative Action University.
It is committed to education of a non-racially identifiable student body.



The University of Memphis, a Tennessee Board of Regents institution, is an Equal Opportunity/Affirmative Action University. It is committed to education of a non-racially identifiable student body.

THE UNIVERSITY OF
MEMPHIS®

NSSLHA
Memphis Speech and Hearing Center
807 Jefferson Ave.
Memphis, TN 38105

Nonprofit Organization
U.S. Postage
Memphis, TN
Permit No. 207



MID-SOUTH CONFERENCE ON COMMUNICATIVE DISORDERS REGISTRATION FORM

COMPLETE THIS ENTIRE FORM (TYPE OR PRINT) (One per person)

If you received a brochure or postcard, please list the 3 or 4 digit ID number on the mailing label _____

ASHA CEUs will require the use of an ASHA membership number rather than a social security number.

Please keep my ASHA number on file for future reference. My ASHA number is _____.

Last Name _____ First Name _____ Middle Initial _____ Maiden/Other Name _____ Title _____

Address _____ City/State/Zip _____

E-mail Address _____ Telephone _____ FAX _____

Are you a U of M Alumnus? Yes, Class of _____ No

Place of Employment / University (for badge purposes) _____

Audiologist Speech-Language Pathologist Undergraduate Student Graduate Student Other _____

Special Accommodations Requested _____

Registration Fees:	Postmarked by 2/23/05		After 2/23/05	
	<u>One Day</u>	<u>Both Days</u>	<u>One Day</u>	<u>Both Days</u>
Professionals:	\$80.00	\$110.00	\$105.00	\$135.00
Full-time Student:	\$40.00	\$ 40.00	\$ 40.00	\$ 40.00
Student Group (4 or more):	\$30.00 (each)	\$ 30.00 (each)	\$ 30.00 (each)	\$ 30.00 (each)

Registration Fee \$ _____ Student Professional **Attending:** Thursday Friday Both Days

Lunch on Thursday \$ _____ (\$10.00) **Method of Payment:** check purchase order # _____

Lunch on Friday \$ _____ (\$10.00) Please send me an E-mail confirmation.

Total Amount \$ _____

Please make checks payable to the NSSLHA Mid-South Conference and return this form to: Melissa Clowers, Mid-South Conference, 807 Jefferson Ave., Memphis, TN 38105. A receipt will be enclosed in your packet when you arrive.

This is a change of address: If you have had a change of address, please return the following updated information (even if you will not be attending the conference) so that we can keep you advised of Mid-South Conference events. Or, e-mail a change of address to midsouth@cc.memphis.edu with "Melissa Clowers" as the subject. Thank you.

If you need special arrangements, please contact Melissa Clowers by February 23, 2005.

Is this the first time to attend the Mid-South Conference? yes no

CANCELLATION POLICY: A full refund will be available before March 1, 2005 by making a request in writing to NSSLHA either by mail, fax, or e-mail. After that date a refund minus \$25 will be given with notification of cancellation. No refunds will be available after March 16, 2005. **Refund requests made via answering machine will not be acknowledged.** All refund payments will be made after the conference.

* Groups must send registration materials together. Each group member will need to complete a separate registration form. If you have any questions, please call Melissa Clowers at (901)678-5800, e-mail: mid-south@cc.memphis.edu with "Melissa Clowers" as the subject heading, or FAX (901)525-1282.