

# DinoFire®

## Wireless Presenter User Manual

Be sure to carefully read this user manual before using the wireless presenter and keep it for future reference.

### D05/D06



1

### **WARNING! RISK OF INJURY!**

Laser beam can cause permanent damage to eyes. Do not look into the laser beam or shine the laser beam into your eyes, other peoples' eyes, or pet's eyes.

Keep this device away from Children. This is a working tool, not a toy. It should only be used by adults.

Information in this document is subject to change without notice. No part of this document may be reproduced or transmitted in any form or by any means, electronic or mechanical, for any purpose, without prior permission of the seller.

The seller provides this document without warranty, or condition of any kind. The seller may make improvements or changes in the product described in this document at any time.

#### **Chapter 1 Introduction**

##### **I. Product description**

It is a great tool for PowerPoint presentations! With it, you can interact with your audiences and still maintain control of your laptop or PC. You don't need to stand beside your computer or blackboard. With it you have complete control!

You can effortlessly deliver your best PowerPoint presentations with the wireless presenter, highlight important details with the laser pointer and manage the presentation within a 30 meters range.

##### **II. Features**

- 1) Up to 30 meters wireless range

2

With 30 meters wireless range, you can stroll around every corner of the conference room or present from the back of the classroom.

2) Support hyperlinks

It combines the functions of a laser pointer, page up, page down, play slides, black screen for PowerPoint presentation. Through 0 Button, the wireless presenter supports hyper link in the PowerPoint.

3) On/off power switch

The wireless presenter is equipped with an on/off power switch.

4) 2.4G RF frequency, which is an ISM free frequency and can be used world-wide.

5) Plug-and-play simplicity

The mini USB receiver supports plug and play technology. No driver is required. Just plug the receiver into the USB port of a laptop and it starts to work within a few seconds.

**III. Who should have this device?**

All the people who present with PowerPoint and a projector, such as teachers, trainers, businessmen, will need this device.

**IV. Operation system**

Windows 2003, XP, Windows Vista, Windows 7, Windows 8, Mac OS, Linux, Android

**V. Package contents**

- 1) Wireless presenter \* 1 (USB receiver included)
- 2) User Manual \* 1

**VI. Specifications**

**Transmitter**

Technology:	Radio Frequency
Frequency:	2.4GHz
Control Distance:	>50m
Laser	Class 3R
Max Output:	<5mW
Laser Distance:	>200m
Wavelength:	650nm
Battery:	AAA*1 (not included)
Working Voltage:	1.5V
Dimension:	139.2*18.2*19.7mm
Weight:	22g

**USB Receiver**

Operation System:	Windows 2003, XP, Vista, Windows 7/8, Mac OS, Linux, Android
USB Version:	USB 2.0
Working Voltage:	5V DC
Dimension:	26.5*12.7*5.5mm
Weight:	2g

## Chapter 2 Getting Started

### VII. Function map

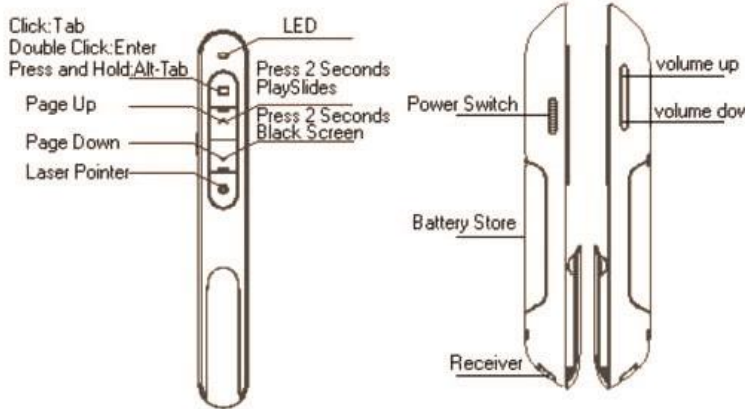

### VIII. Function Description

- 1) Open Microsoft PowerPoint and PowerPoint files.
- 2) Press "Page Up" button for 2 seconds to play slides from the current page.  
Press the button for 2 seconds again to escape from the full screen
- 3) Press "Page Down" button and "Page Up" button to go forward and backward.
- 4) Press and hold "Laser Pointer" button to turn on the laser, release button to turn it off.
- 5) If hyperlinks exist on the page, click  button, you can jump among the hyperlinks and double click can be used to open the hyperlink.
- 6) After the hyperlink is opened, you can press and hold  button to switch between all opened application windows. Release it to turn to the window you

want to switch to.

7) Press volume up or volume down, you can adjust system volume.

If you find out the up and down keys in using don't did the work what you want it to do, please press "A" and "V" keys 1 second at the same time. After the indicator light flashing, you can loosen your fingers. In this way, presenter can switch to one of the three modes:

1. The Page Up and Page Down.
2. The Up and Down.
3. The right and left.

### IX. Installation

- 1) Install battery

Open the presenter battery store cover, and base on battery electrode sign to install battery. Refer to the below figures:

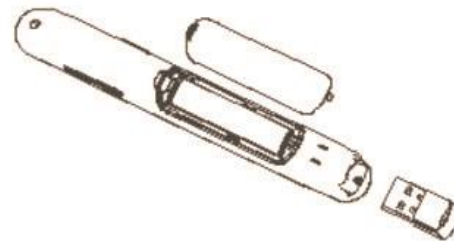

- 2) Take out the mini USB receiver from the wireless presenter

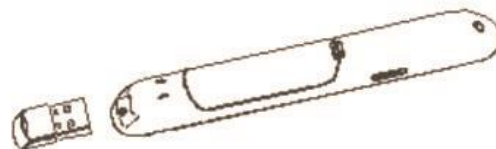

Take out the mini USB receiver from the wireless presenter. Push the power switch to on position; you can press any button to check whether the power is on or not. If the LED is flashing when the button is pressed, it means the wireless presenter is turned on.

3) Install the USB receiver

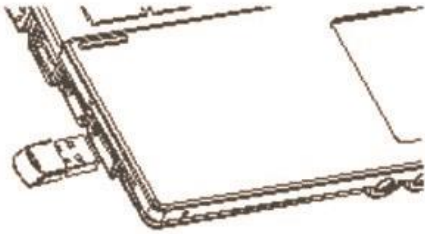

Please plug the receiver into the laptop's USB port. The system will automatically detect the device. Follow the steps to search the driver of the USB device and complete the setup.

4) Operate the wireless presenter

When a button is pressed, the blue LED on the wireless presenter will flash. When the USB receiver receives control signal, the LED on the USB receiver will flash too.

5) Turn off the wireless presenter

Plug the mini USB receiver into the wireless presenter, and push the power switch to off position.

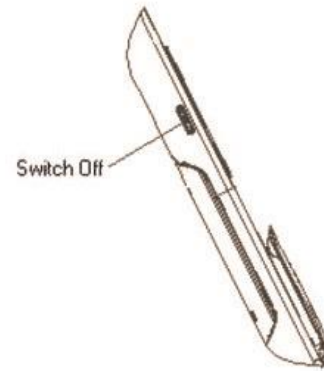

Chapter 3 Frequently Asked Questions

1) How to know the battery is out of power?

If the blue LED on the wireless presenter starts to flash slowly, it means the power is low and the battery needs to be replaced.

2) The laser pointer does not work, why?

Firstly you need to turn on the power. Secondly you can check whether the wireless presenter is in low power or out of power. If the LED flash slowly, it means the power is low and the battery needs to be replaced. If all the other buttons can work, only the laser pointer cannot work, the laser diode may need replacement.

3) When the mini USB receiver plugs into the PC USB, the laptop does not detect the device, why?

Please try another USB port or another PC.

## The operation of MAC first time identifying the presenter:

① Plug the USB receiver, please click "continue" when it comes out a window as below :

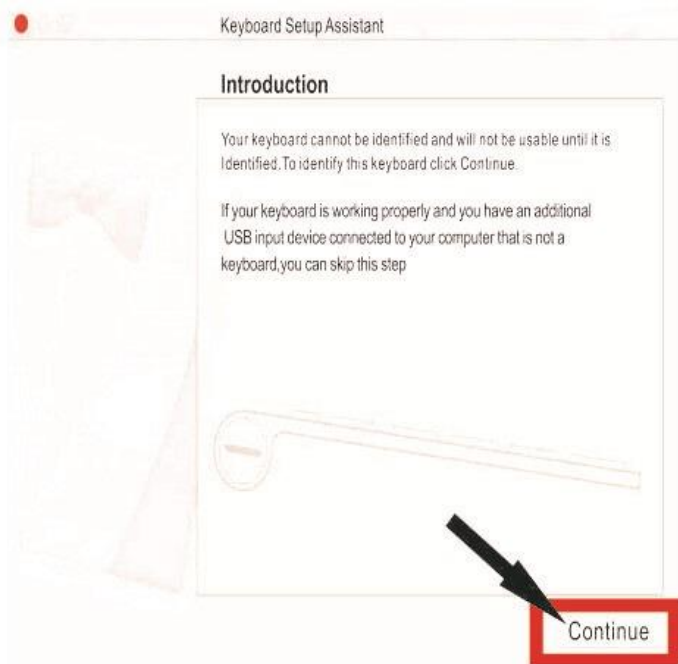

② Press the next page or previous page key when it comes out a window as below, and then wait for 5 seconds :

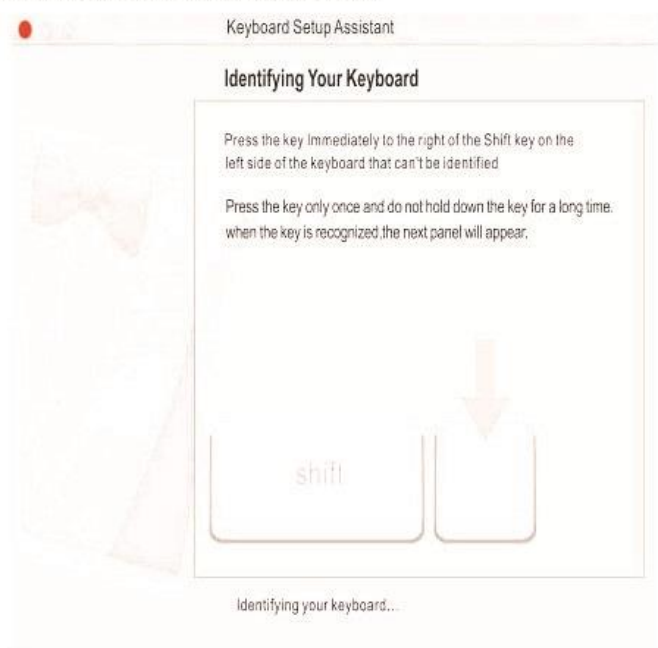

9

③ After your 5 seconds waiting, please click "OK" when it comes out a window as below :

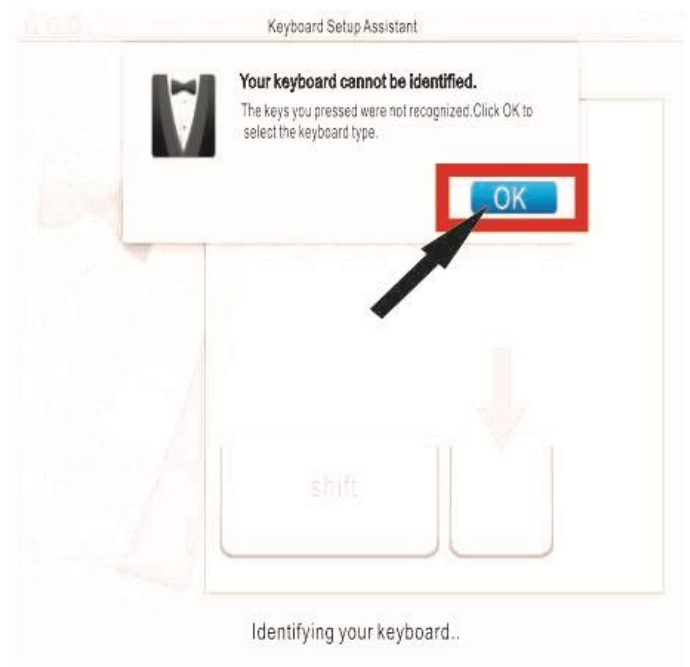

④ Please select ANSI option and click "done" when it comes out a window as below :

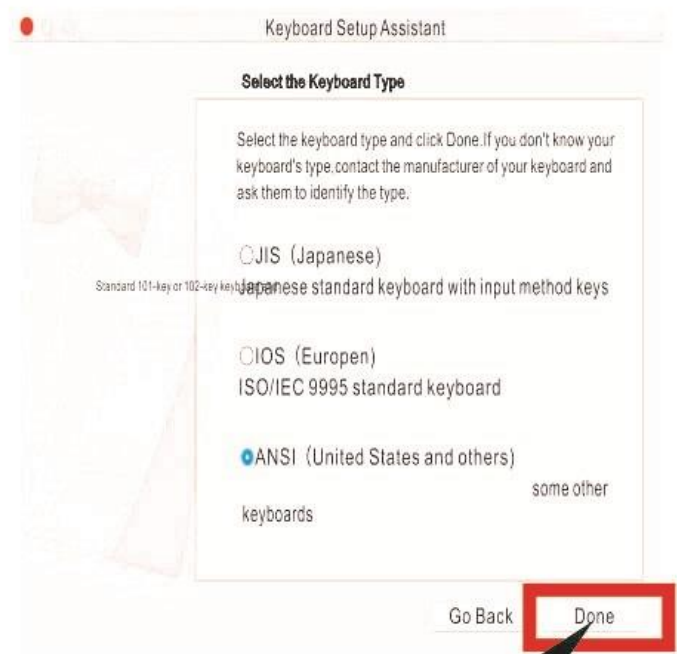

10

⑤. Re-identify

Choose [System Preferences]



Choose [Keyboard]



Choose [Change Keyboard Type...]

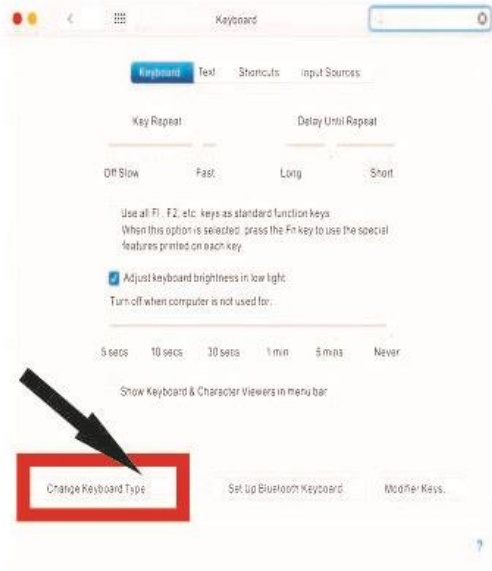

Repeat step ①②③④