

# Adding UofM Mail to Android OS

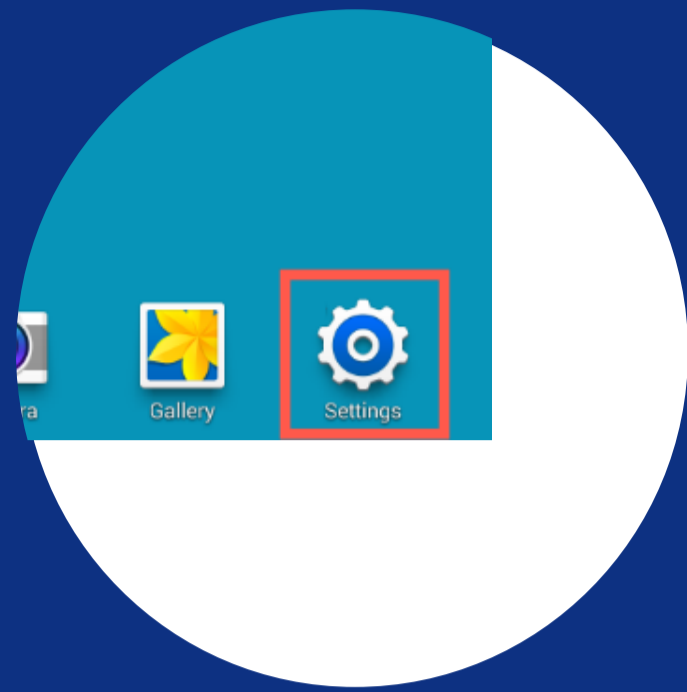

Tap **Settings**

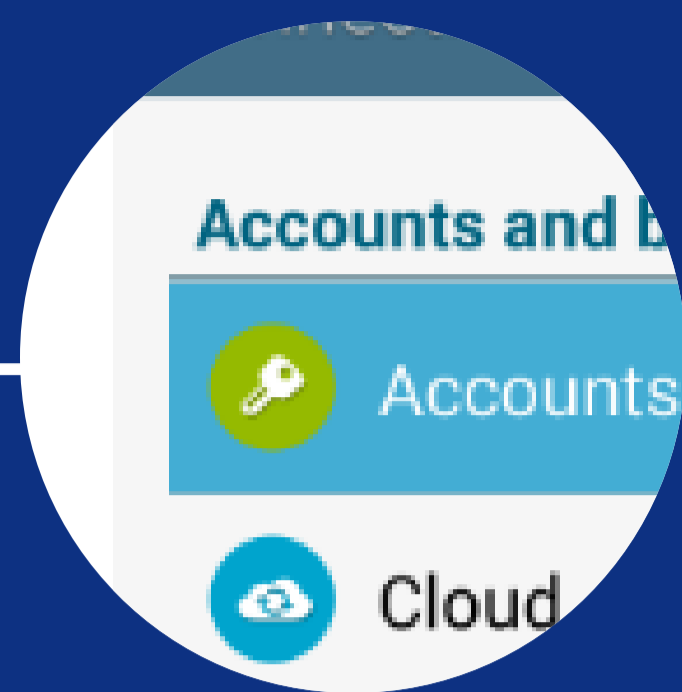

Tap **General**  
Tap **Accounts**  
Tap **Add Account**

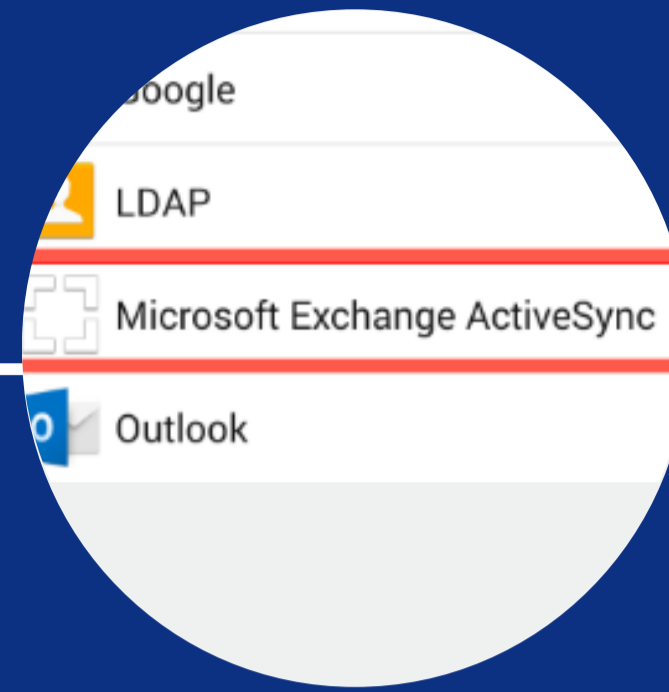

Tap **Microsoft Exchange Active Sync**

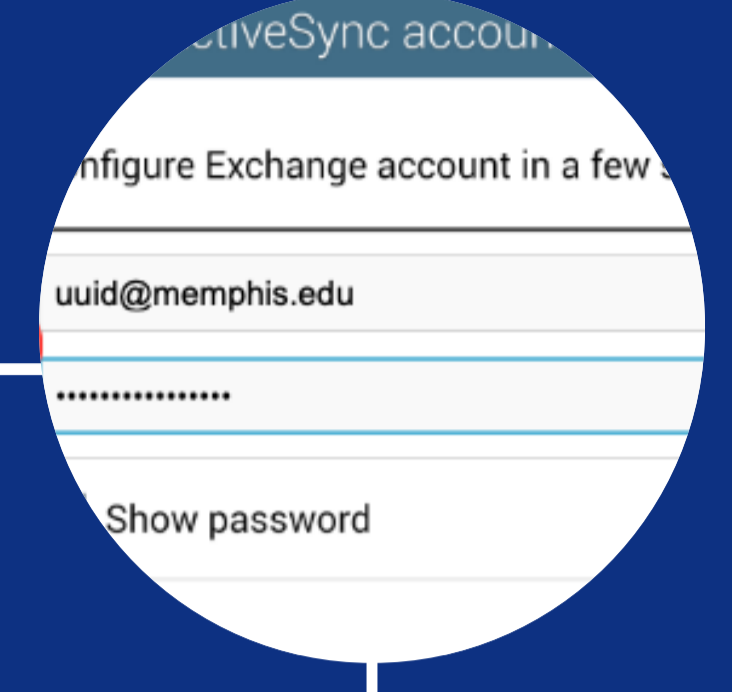

Enter your email address (uuid@memphis.edu) and your email password. Click **OK**.

\*Click **Manual Setup**, if setup could not connect to the server.



Enter the following information:  
**1. Domain\Username:** username@memphis.edu  
**2. Password:** your University of Memphis password  
**3. Exchange Server:** outlook.office365.com  
Domain: if available, leave blank

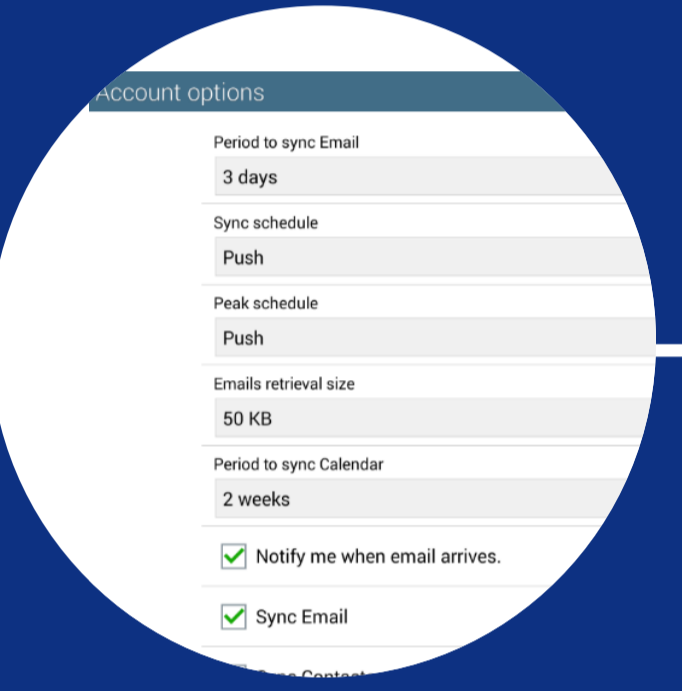

Select your Account Options. Click **Next**.

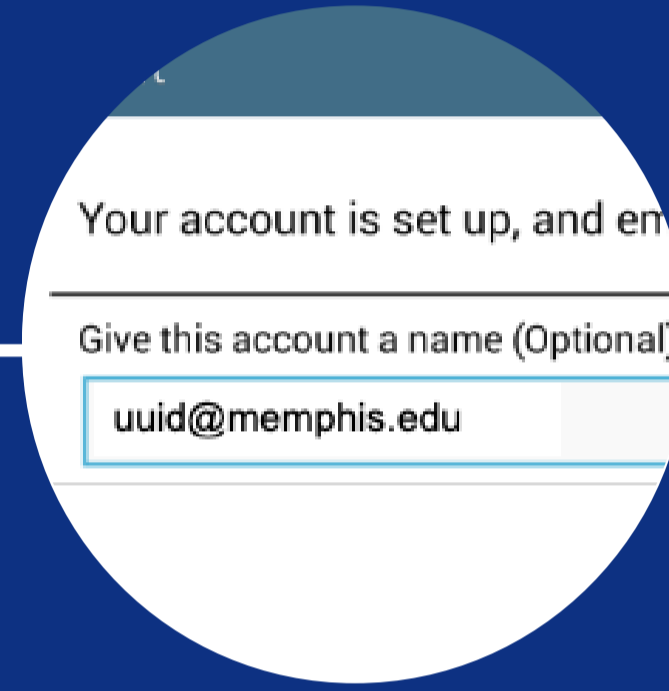

Name your account. Click **Done**.

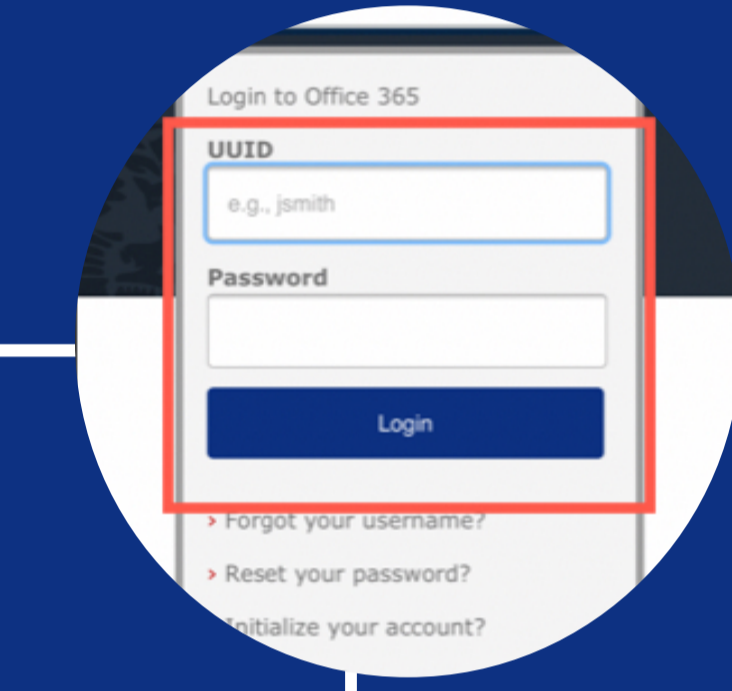

Enter your UUID and password and click **Login**

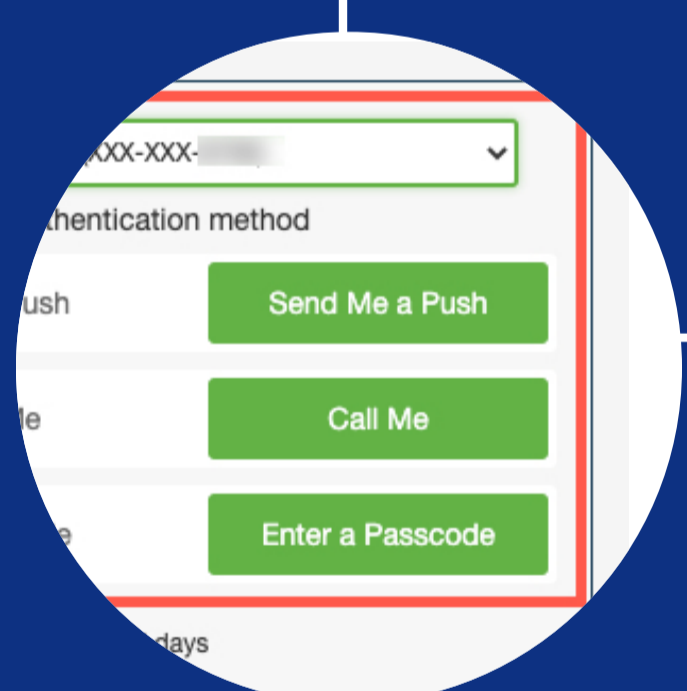

Duo authentication prompt will pop up. Select the method of authentication.

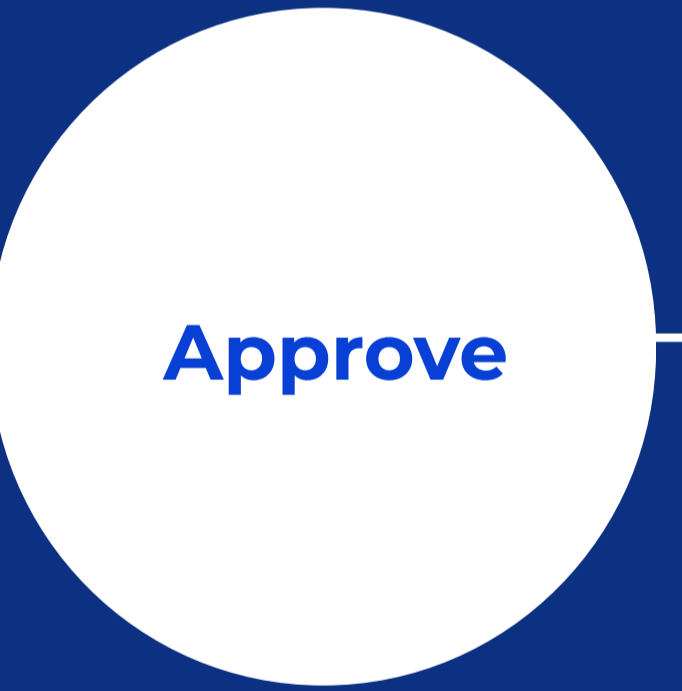

A push notification will display. Approve the authentication using Duo.

## You've added your email!

**For further more detailed instructions see our documentation.**

**\*If Asked, enter the following information:**

Email address: username@memphis.edu

Password: your University of Memphis password

Exchange Server: outlook.office365.com

Domain: if available, leave blank